



ENGAGE™ WITH UNICLIC® REPLACEMENT INSTRUCTIONS

These instructions apply to all ENGAGE™ with UNICLIC® plank and tile formats.



TOOLS NEEDED

- Carpenter's Square
- Small Circular Power Saw
- Prevail™ Tapping Block
- Prevail™ 30-GS Adhesive
- Marker
- Safety Glasses
- Prevail™ Hand Roller
- Prevail™ Remove-All
- Utility Knife
- Shop Vac
- Sheetrock Tape (*See back page)
- Clean, White, Lint-Free Cloth
- Small Chisel
- Lightweight Rubber Mallet

BEFORE YOU BEGIN

Acclimate the repair material 48 hours prior to installation. Maintain the ambient temperature between 65° and 85° F, and relative humidity between 35% and 85% before, during and after the repair.

REMOVE THE DAMAGED PLANK



1 Measure 1-1/2" inside the perimeter of the damaged plank, and mark.



2 Mark diagonal stopping points on the four corners of the damaged plank.



3 Use a plank as a gauge to set the saw blade to the proper depth to avoid cutting through the subfloor.



4 Carefully cut along the perimeter marks you made.

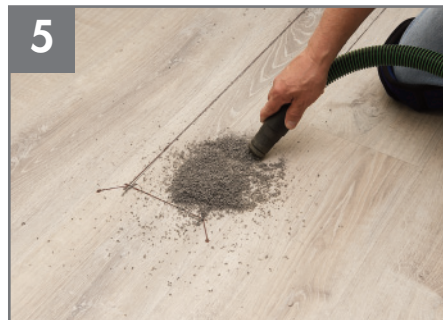

5 Vacuum up the debris.

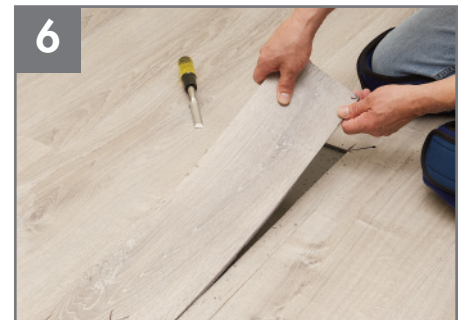

6 Remove the center section, using a small chisel to lift the first edge.



7 Carefully cut the diagonals. Vacuum up the debris.



8 Remove the remaining strips of material from the long and short edges.



9 Remove the lock from the long and short edges of the surrounding material with a small chisel. Vacuum up debris.



ENGAGE™ WITH UNICLIC® REPLACEMENT INSTRUCTIONS

These instructions apply to all ENGAGE™ with UNICLIC® plank and tile formats.



INSTALL THE REPLACEMENT PLANK

***NOTE:** If there is no underlayment installed under the Engage™ flooring, protect the subfloor from adhesive by sliding strips of sheetrock tape under the exposed perimeter edges of the repair before proceeding with the repair.



Remove the lock on the long and short sides of the replacement plank.



Cut off the corner where the two grooved edges meet.



Remove the long, tongue edge of the replacement plank.



Apply a scant bead of Prevail™ 30-GS to the exposed groove sides of the flooring surrounding the repair.



Apply a scant bead of Prevail™ 30-GS to the groove sides of the replacement plank.

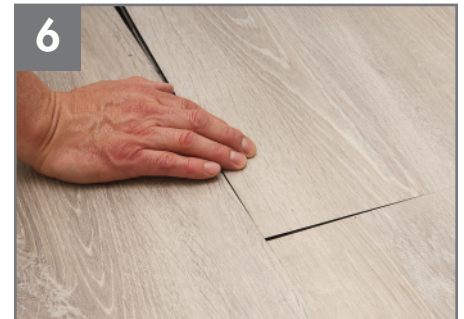

Align the cut corner first, then drop the replacement plank into position.



Use the Prevail™ Tapping Block on the long and short sides to ease the replacement plank into place. Hand roll the joints.

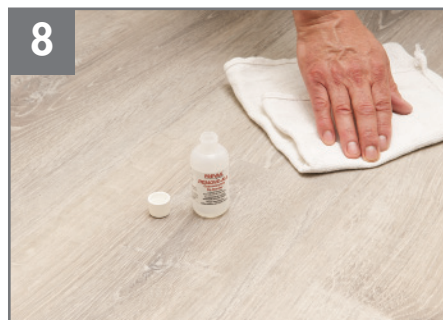

Remove excess adhesive immediately using a small amount of Prevail™ Remove-All applied with a clean, white lint-free cloth. Never pour directly onto the floor.



Weigh down the repaired section and allow to dry completely.



For technical inquiries and further information, contact Metroflor® Technical Support Services at (888) 235-6672.